

Graffiti Off-Brick for Porous Surfaces



Product Usage Guide

Professional



BG160-5

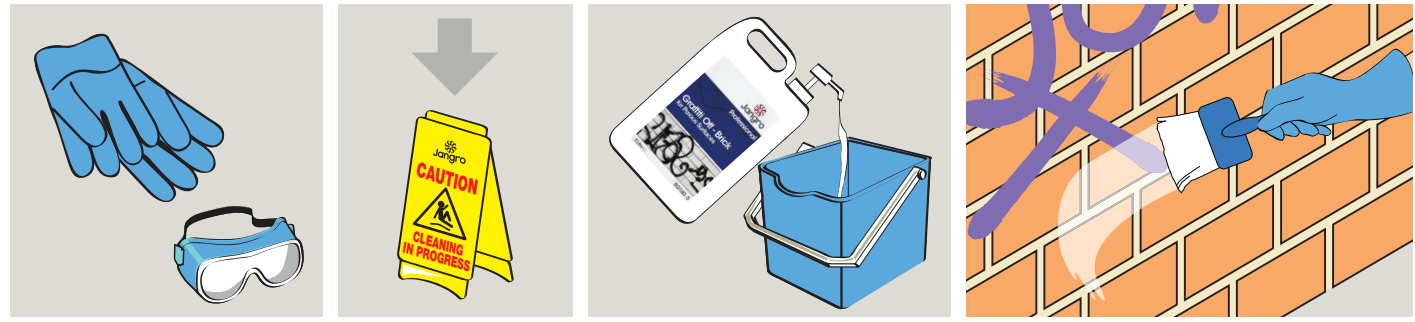

- 1 Use appropriate PPE as indicated in the Safety Data Sheet.
- 2 Place Safety Signs.
- 3 Pour product neat into a clean bucket.
- 4 Apply evenly across the graffiti.

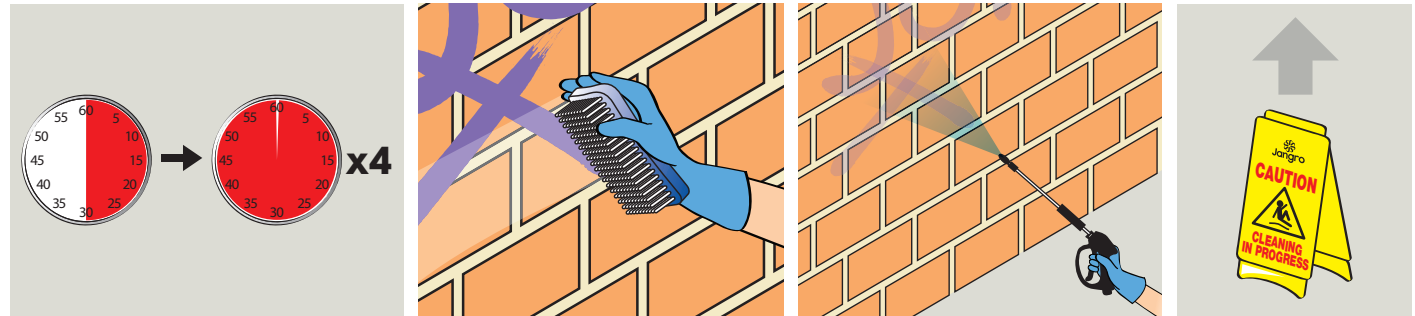

- 5 Allow product to penetrate for 30 minutes to 4 hours.
- 6 Agitate graffiti with stiff brush.
- 7 Remove using pressure washer with water.
- 8 Remove Safety Signs.

Health & Safety

Please refer to the Safety Data Sheet



Scan for further product details



For non-porous surfaces i.e. metal, graffiti can be scraped off or wiped off with paper towel.